



CHURCH · FAMILY · CELEBRATION



**MOVING FORWARD**  
*GROWING YOUNG*

[CELEBRATIONFAMILY.COM](http://CELEBRATIONFAMILY.COM)





THIS BOOK BELONGS TO:

---

**CONSECRATE YOURSELVES,**  
for tomorrow the **LORD** will  
do **WONDERS** among you.

Joshua 3:5

I write with a sense of déjà vu. Three years ago, we started this journey of planning and building for our future. We held several gathering groups to hear from our church family and to cast vision for where we were going. I remember from the fall of 2019 through the winter of 2020 being one of the best seasons in Celebration's history. Our church was united and excited about what God was doing and going to do. And then Covid. The world came to a halt. The pandemic darkness clouded any thought of a bright future.

While these past three years felt much like the wilderness wanderings of the Israelites in the OT, we now stand ready to move toward a brighter future. We are a different church, however. During the past three years we have seen many new people come into our church family who know very little about our history or our dreams and plans back in 2019.

As I reflect on the challenges we experienced because of the pandemic and the faithfulness of God to bring us through, I realize that has been the journey of Celebration Church since the beginning. Our history has been filled with moments where we encountered trials and obstacles, yet knowing all along that God had his hand on our church and was opening the way for us to move forward.

When Leigh Anne and I started the church in 1997 with our children – one, three and six years old, God graciously provided a handful of people to join us. We all shared a dream of seeing God plant a vibrant church in the South Hall/North Gwinnett area. We knew that the journey ahead would be challenging; there would always be decisions to make about moving forward.

We began by walking the streets of subdivisions and knocking on doors inviting people to join us at the Friendship Elementary School gym. As we gave everyone a Celebration chip clip holding information about our worship services, we asked them to be a part of a new work – a church with no building, no programs, and no weekday ministries.

Our goal then was to love God and to love each person He brought to us in that school gym. Though we were lacking in resources, we gave all we had by pouring our hearts into the people God sent us. More important than buildings and programs, we knew people needed to hear of their God-given worth and the Good News for their lives offered through Jesus Christ.



Celebration Church began meeting in Friendship Elementary School in October 1997.



We broke ground on our current property in 2001.



We held our first worship service in our current building Memorial Day Weekend 2002.



As people began joining us, we realized a decision had to be made to move us forward, to establish a home location for this growing Celebration family. In 2002, we moved from the gym at Friendship Elementary School to our current property on Thompson Mill Road. We began expanding our ministries but always with the core value to love people as God loves them and to help them understand their value to God.

Now here we are in 2022 with an opportunity to take a major step forward in our ministry to this growing community. I want to promise you, however, that the basic beliefs and practices that made up who we were in 1997, will continue to guide who we are today. We will always be about loving people as Jesus loves them. And as we are experiencing, this type of church attracts more people.

As it stands today, we have multiple issues that need addressing for us to continue to make a kingdom impact. First, our limited worship space continues to inhibit reaching the increasing number of new people moving into our community and also providing the desired environment for our traditional and contemporary worship services. Second, logistical concerns with two disconnected buildings pose challenges for young families and for connecting our church family on Sunday morning. Third, our community will continue to grow at a rapid rate in the years ahead. We must be proactive in providing worship and classroom space if we are to offer relevant ministry to people of all ages moving into our area. Whereas some churches have decided to focus ministries only on young people and other churches have resigned to only have an older age group, our leadership sees an opportunity for Celebration to be a strong intergenerational church where our ministries bring together children, parents and grandparents for worship, ministry, and fellowship. Thus, as we move forward, we will be intentional in investing in the next generation while also caring and providing ministry opportunities for all ages.

This initiative, ONE Celebration: Moving Forward-Growing Young, is about fulfilling the next step that God has for Celebration Church. It will take sacrifice. It will require investment in the kingdom purpose. It can be done. And there is no other group of people with whom I would rather be on this journey.

Moving forward and growing young,



Pastor Mike Day



It wasn't long before we outgrew the space and moved our Children and Youth Ministries into trailers.



In August 2012, we opened our new Children and Youth building.



In September of 2018, we added a third worship service, and the Traditional service moved to the gym.

# WHAT ARE WE DOING?

## **UNIFYING THE CAMPUS ARCHITECTURE**

We will bring our congregation together under one roof. Our worship spaces and classrooms will be connected by hallways that enable you to move easily so that there is a flow to where, even though you may be in a classroom that is on the other side of the church campus, you can walk the hallways easily. Our traditional and contemporary worship services will both take place under one roof.

## **CREATING A DISTINCT TRADITIONAL WORSHIP SPACE**

People will have a sense of awe and reverence when they enter this sanctuary. Room on the platform will provide space for our growing choir and future orchestra. This worship space will seat 250 - 300 people.

## **CREATING A DISTINCT CONTEMPORARY WORSHIP SPACE**

Our contemporary sanctuary will offer a modern setting with state of the art technology and lighting. Expanded seating will be available for special services such as baptisms, Christmas Eve, and Celebration Academy programs and graduation. This worship space will seat 500-700 people.

## **DESIGNING A CENTRALIZED GATHERING SPACE**

This gathering space will allow people from both the Contemporary services and the Traditional service to gather and fellowship together. Places will be provided to grab a cup of coffee, meet up with invited guests, or sit down for an engaging conversation.

## **ADDING & EXPANDING CLASSROOMS FOR ALL AGES**

We will centralize all our children activities and classrooms in one area. No longer will parents have to move back and forth between buildings to get children of various ages to different rooms. The youth will hold all their activities back in their gym and classrooms. Finally, additional adult classrooms will provide opportunities for growing bible studies and small groups.

# WHY ARE WE DOING IT?

Our current challenge is multi-faceted:

- **Space Issue:** We are overcrowded and are forced to make decisions based on capacity rather than on ministry.
- **Logistics Issue:** We are two buildings, separated with no connection. Because our worship services take place in separate buildings, this divides our church family.
- **Community Issue:** Our community is growing by leaps and bounds! We have seen over 100,000 people move into our surrounding area each year over the past several years. The growth forecast shows a continuous pattern of increase for this next decade. We see the growth around every corner in neighborhoods, schools, and healthcare!

# WHY ARE WE DOING IT NOW?

Our goal is to be obedient to the call God gave over twenty-five years ago when Celebration was started. Celebration was launched to be a vibrant church for all ages. For us to continue to offer a place where people can connect with God and with others, we must expand our facilities.

Studies have shown that when a visitor shows up at a church that is over 70% full, there is a message to that visitor that they're not welcome or that they're not needed. Rather than being a church that is inviting and open to all people, we communicate to our community that we are inward-focused. If we don't do something, we will begin to plateau and eventually decline.

God created the Church to be His vehicle for shining the light of Christ and sharing the gospel in our community and around the world. Matthew 5:14-16 tells us we are not to hide the light of Christ, but to shine our light before others so that our Father may be glorified.

Our foundation has always been to love people as Jesus loves them. Without expanding, we are unable to fully achieve this in our community. ONE Celebration will help accomplish this as we fulfill the next step that God has for Celebration Church.



This new building will take us to a place that makes us more impactful as we fulfill the next step that God has for Celebration Church.

By unifying the campus architecture, we will bring our congregation together under one roof. We will have more space for:

- Worship
- Children & Youth
- Fellowship
- Studies & Connections

Our ministry will no longer be limited by capacity.

**FULFILLING THE NEXT STEP THAT GOD HAS FOR CELEBRATION CHURCH**



## THOMPSON MILL ENTRANCE



The Thompson Mill Road Entrance provides easy access to the new Contemporary Worship Center (right) as well as to the Children & Youth Building (left).

## FRIENDSHIP ENTRANCE



As you enter the campus from Friendship Road, you will find yourself in our Friendship Road Parking Lot. The Traditional Worship lobby is to the right and the Contemporary Worship lobby is by the cross.



## FRIENDSHIP ENTRANCE



The Friendship Road Entrance leads to the primary parking lot for our Traditional Worship service. The Traditional Worship lobby is to the right and the Contemporary Worship lobby is directly ahead.

## THOMPSON MILL ENTRANCE



As you enter the campus from Thompson Mill Road, this entrance is directly ahead of you. This entrance provides access to our Children & Youth Building as well as our Contemporary Worship Center.

## TRADITIONAL LOBBY



The Traditional Worship Lobby will provide a place for gathering before and after worship.

## TRADITIONAL SANCTUARY



The Traditional Sanctuary will be a beautiful space that has a sense of awe and reverence. The sanctuary will seat 250-300 people and will include a large platform for a growing choir and the space itself will be adorned with stained glass.



## CONTEMPORARY WORSHIP



The Contemporary Worship Center will seat 500-700 people and will be the home for our two Contemporary Worship services. This new space will provide ample seating as we welcome our community on Sunday mornings as well as for special services and community events.

## LOBBY



The new lobby outside the Contemporary Worship Center will connect Contemporary and Traditional worship spaces. This will allow for fellowship and connections to take place.

# THE CONSTRUCTION PLAN

As you can see from this campus footprint, the new construction will be built where the sidewalk between our two buildings currently is, moving out into the field and existing parking lot. Additional parking will be added, and access to the church will still be available from both Friendship Road and Thompson Mill Road.

It is estimated that construction will take approximately two years once we begin, and the plan is to continue with our worship schedule as-is while we can as construction takes place, understanding that we all will have to be flexible with some of the growing pains that are to be expected.

- UNIFYING CAMPUS ARCHITECTURE
- CREATING A DISTINCT TRADITIONAL WORSHIP SPACE

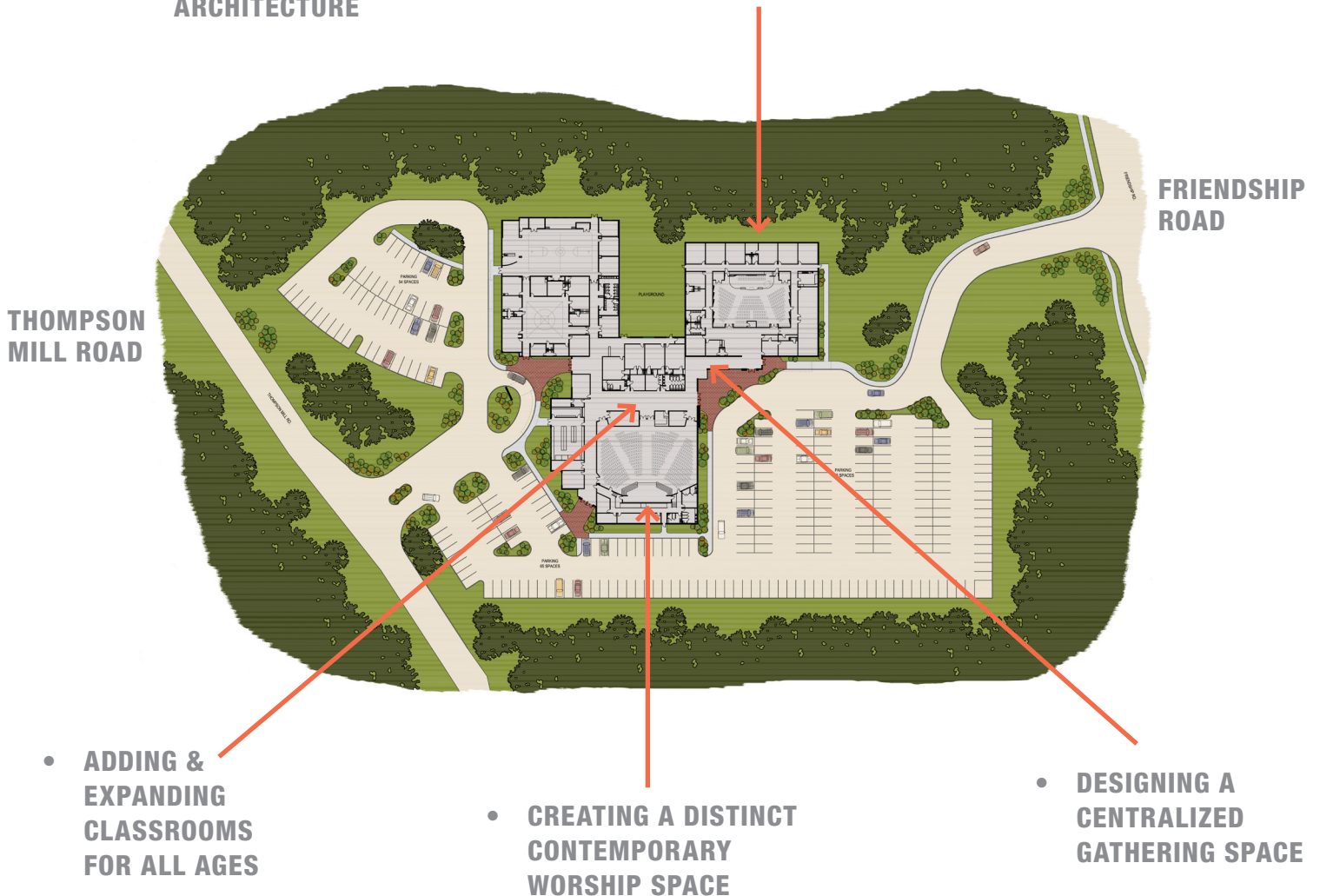



- **UNIFYING CAMPUS ARCHITECTURE**

- **CREATING A DISTINCT TRADITIONAL WORSHIP SPACE**

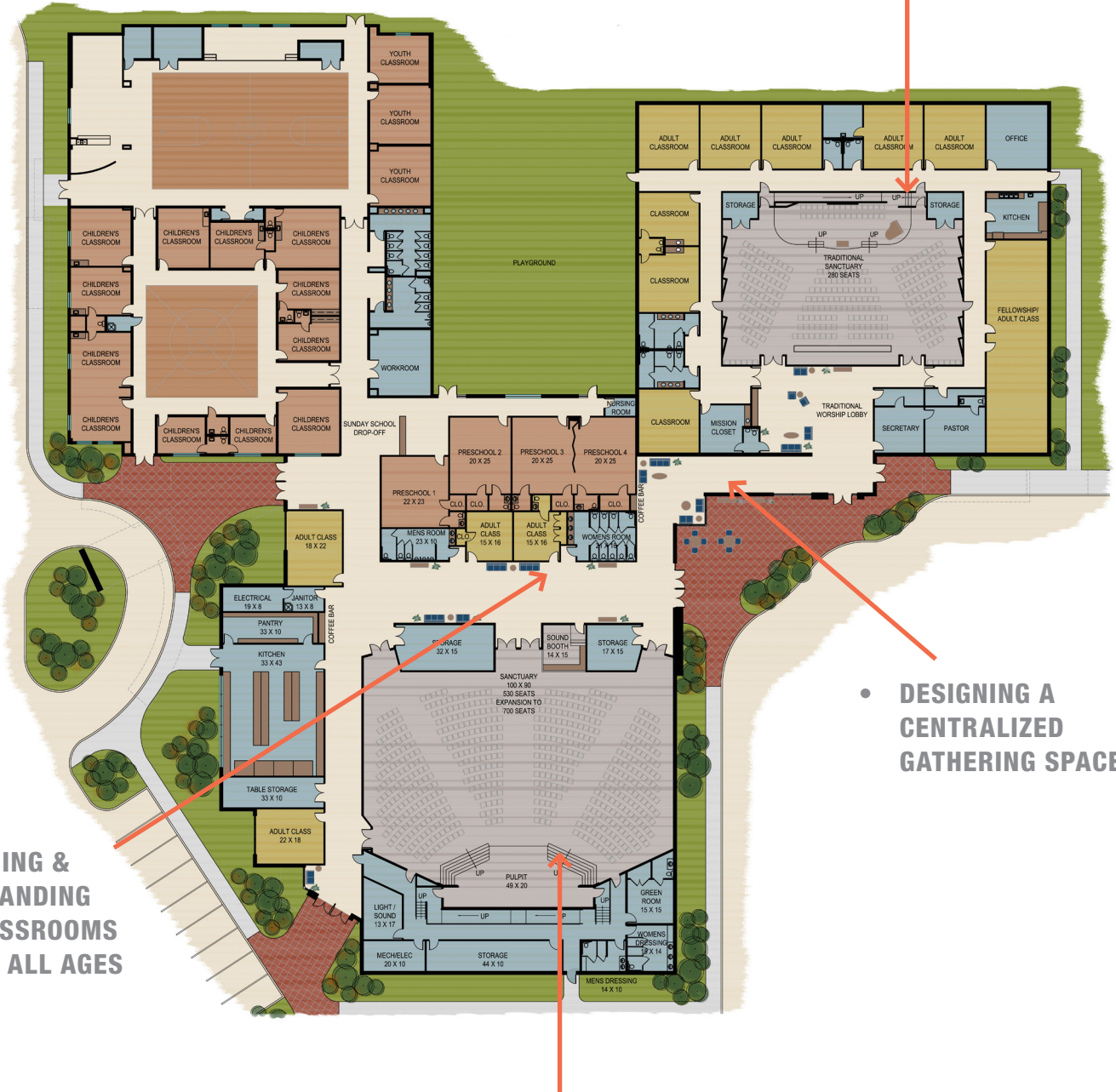

- **DESIGNING A CENTRALIZED GATHERING SPACE**

- **ADDING & EXPANDING CLASSROOMS FOR ALL AGES**

- **CREATING A DISTINCT CONTEMPORARY WORSHIP SPACE**



# PROJECTED COST

\$8-9 million

# HOW WILL THE PROJECT BE FUNDED?

Each family in our church will be given the opportunity to make a three-year commitment over and above their regular giving on **SUNDAY, NOVEMBER 13**, which is Commitment Sunday.

In order for this initiative to become a reality, this is going to take two things:

- 100% participation from everyone who calls Celebration their church home
- Every one of us committing to give sacrificially for something bigger than us that has an eternal impact.

# FAQS

**WHAT WILL THE WORSHIP SCHEDULE BE?** Our worship schedule will remain the same as it currently is:

9:00 Contemporary Worship

10:00 Traditional Worship

11:00 Contemporary Worship

## **WHERE WILL MY KIDS GO?**

Celebration Kids (Babies - 5th Grade) will have a centralized check-in and centralized classrooms in the Children & Youth Building.

Celebration Students will return to their original home in the gym and adjacent classrooms.

Dear Church Family,

The challenge before us is a large one. This gift profile shows how it will be possible for us to secure our goal for this initiative. The chart reveals that even with the large task God has given us, it is possible to move forward. It also shows that every gift — no matter the size — makes a difference.

As you look at the guide, your eyes will likely settle first on the level you have been considering for our campaign. You can see how that gift will strengthen our faith family and enable us to press forward with our vision. However, before you make a commitment on Commitment Sunday, I would ask you to pray about moving up one step on the chart. Only you know if that step is possible, but I encourage you to open your heart in the coming days to that possibility and let God shape your response.



Pastor Mike

## GIFT PROFILE GUIDE \$4,000,000

### Three Year Commitments

# of Commitments at Each Level	Amount of Each Commitment
1	\$500,000
2	\$250,000
4	\$100,000
6	\$75,000
10	\$50,000
12	\$36,000
15	\$24,000
20	\$15,000
25	\$10,000
25	\$7,200
35	\$3,600
Other Commitments	Under \$3,600

This giving schedule is for quick calculation of weekly, monthly, and yearly giving. No one should feel confined to this schedule.

Total 3 Year Commitment	Annually	Monthly	Weekly
\$500,000	\$166,667	\$13,889	\$3,205
\$250,000	\$83,333	\$6,944	\$1,603
\$100,000	\$33,333	\$2,778	\$641
\$75,000	\$25,000	\$2,083	\$481
\$50,000	\$16,667	\$1,389	\$321
\$36,000	\$12,000	\$1,000	\$231
\$24,000	\$8,000	\$667	\$154
\$15,000	\$5,000	\$417	\$96
\$10,000	\$3,333	\$278	\$64
\$7,200	\$2,400	\$200	\$46
\$3,600	\$1,200	\$100	\$23

# WHEN WILL WE MAKE OUR COMMITMENT?

**COMMITMENT SUNDAY** is November 13.

This sample commitment card is provided to assist you in the calculation of your three-year financial commitment.

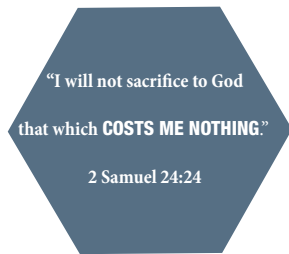

Date: \_\_\_\_\_

Name: \_\_\_\_\_

Address: \_\_\_\_\_

Phone Number: \_\_\_\_\_

Email Address: \_\_\_\_\_

Over the next **THREE** years, I/We plan to give accordingly:

\$ \_\_\_\_\_ Weekly for 156 weeks

\$ \_\_\_\_\_ Monthly for 36 months

\$ \_\_\_\_\_ Annually for 3 years

I/We wish to give to the **ONE Celebration** Initiative by means other than cash.

Description: \_\_\_\_\_

\_\_\_\_\_

Estimated value of asset given: \_\_\_\_\_

*Stocks, Bonds, IRA Distributions, Securities, Personal Property, Appreciated Real Estate, Paid-Up Insurance Policies, and Charitable Trusts are all examples of non-cash donations.*

Signature: \_\_\_\_\_

Your commitment is an indication of your intention to give as you are able.





CHURCH · FAMILY · CELEBRATION

## SERMON SERIES

September 25, 2022

### ONE CELEBRATION: MOVING FORWARD

---

#### SCRIPTURE - JOSHUA 3:1-17

Then Joshua rose early in the morning and they set out from Shittim. And they came to the Jordan, he and all the people of Israel, and lodged there before they passed over. 2 At the end of three days the officers went through the camp 3 and commanded the people, “As soon as you see the ark of the covenant of the Lord your God being carried by the Levitical priests, then you shall set out from your place and follow it. 4 Yet there shall be a distance between you and it, about 2,000 cubits in length. Do not come near it, in order that you may know the way you shall go, for you have not passed this way before.” 5 Then Joshua said to the people, “Consecrate yourselves, for tomorrow the Lord will do wonders among you.” 6 And Joshua said to the priests, “Take up the ark of the covenant and pass on before the people.” So they took up the ark of the covenant and went before the people.

7 The Lord said to Joshua, “Today I will begin to exalt you in the sight of all Israel, that they may know that, as I was with Moses, so I will be with you. 8 And as for you, command the priests who bear the ark of the covenant, ‘When you come to the brink of the waters of the Jordan, you shall stand still in the Jordan.’” 9 And Joshua said to the people of Israel, “Come here and listen to the words of the Lord your God.” 10 And Joshua said, “Here is how you shall know that the living God is among you and that he will without fail drive out from before you the Canaanites, the Hittites, the Hivites, the Perizzites, the Girgashites, the Amorites, and the Jebusites.



# SCRIPTURE CONTINUED

11 Behold, the ark of the covenant of the Lord of all the earth is passing over before you into the Jordan. 12 Now therefore take twelve men from the tribes of Israel, from each tribe a man. 13 And when the soles of the feet of the priests bearing the ark of the Lord, the Lord of all the earth, shall rest in the waters of the Jordan, the waters of the Jordan shall be cut off from flowing, and the waters coming down from above shall stand in one heap.”

14 So when the people set out from their tents to pass over the Jordan with the priests bearing the ark of the covenant before the people, 15 and as soon as those bearing the ark had come as far as the Jordan, and the feet of the priests bearing the ark were dipped in the brink of the water (now the Jordan overflows all its banks throughout the time of harvest), 16 the waters coming down from above stood and rose up in a heap very far away, at Adam, the city that is beside Zarethan, and those flowing down toward the Sea of the Arabah, the Salt Sea, were completely cut off. And the people passed over opposite Jericho. 17 Now the priests bearing the ark of the covenant of the Lord stood firmly on dry ground in the midst of the Jordan, and all Israel was passing over on dry ground until all the nation finished passing over the Jordan.

# SERMON NOTES

Moving Forward Brings \_\_\_\_\_

Moving Forward Brings \_\_\_\_\_

Moving Forward Brings \_\_\_\_\_

Moving Forward Requires the \_\_\_\_\_



CHURCH · FAMILY · CELEBRATION

## SERMON SERIES

October 2, 2022

### ONE CELEBRATION: UNLOCK KEY CHAIN LEADERSHIP

---

#### SCRIPTURE - ACTS 6:1-7

Now in these days when the disciples were increasing in number, a complaint by the Hellenists arose against the Hebrews because their widows were being neglected in the daily distribution. 2 And the twelve summoned the full number of the disciples and said, “It is not right that we should give up preaching the word of God to serve tables. 3 Therefore, brothers, pick out from among you seven men of good repute, full of the Spirit and of wisdom, whom we will appoint to this duty. 4 But we will devote ourselves to prayer and to the ministry of the word.” 5 And what they said pleased the whole gathering, and they chose Stephen, a man full of faith and of the Holy Spirit, and Philip, and Prochorus, and Nicanor, and Timon, and Parmenas, and Nicolaus, a proselyte of Antioch. 6 These they set before the apostles, and they prayed and laid their hands on them. 7 And the word of God continued to increase, and the number of the disciples multiplied greatly in Jerusalem, and a great many of the priests became obedient to the faith.

# SERMON NOTES

Perspective: Everyone is a \_\_\_\_\_

Practice

---

---

---

“Some leaders **CLING TO THEIR KEYS** tightly and refuse to share them even for a moment, but **KEYCHAIN LEADERS** model a posture of **GIVING AWAY ACCESS AND AUTHORITY**. This posture not only **EMPOWERS** others but also meaningfully **LINKS THEM** to the life of the congregation.”

-*Growing Young*, “Unlock Keychain Leadership”

# SMALL GROUP REFLECTION QUESTIONS

READ ACTS 6:1-7

1. Think back to a time someone gave you “keys” of access, authority, or responsibility, in ministry or elsewhere. What was significant about that for you?

---

---

---

---

2. What might it look like to give young people in high school more leadership in our church? What about college-aged young adults? Twenty-somethings?

---

---

---

---

3. What’s one area where you personally could share a key with a young person?

---

---

---

---

4. We usually associate only positive outcomes with growth. How can growth also bring challenges?

---

---

---

---

# MOVING FORWARD THROUGH PRAYER

## WEEK 1 - UNLOCK KEYCHAIN LEADERSHIP

- Pray that our church will be built up and unified during this initiative. Pray that we will seek ways to serve each other as we give our money, time, and talents to make this successful.
- Pray for our church staff. Pray for their strength, wisdom, and resources to do the job that the Lord has called them to do.
- “You can download good preaching, but you can’t download a vibrant community.” (Growing Young; Griffin, Mulder, and Powell). Pray that our congregation will be one who focuses on fostering community.
- Think back to a time when someone gave you “keys” of access, authority, or responsibility, in ministry or elsewhere. Pray the Lord will help our church foster a culture of shared leadership with young people.





CHURCH · FAMILY · CELEBRATION

## SERMON SERIES

October 9, 2022

### ONE CELEBRATION: EMPATHIZE WITH TODAY'S YOUNG PEOPLE

---

#### COLOSSIANS 3:12-17

Put on then, as God's chosen ones, holy and beloved, compassionate hearts, kindness, humility, meekness, and patience, 13 bearing with one another and, if one has a complaint against another, forgiving each other; as the Lord has forgiven you, so you also must forgive. 14 And above all these put on love, which binds everything together in perfect harmony. 15 And let the peace of Christ rule in your hearts, to which indeed you were called in one body. And be thankful. 16 Let the word of Christ dwell in you richly, teaching and admonishing one another in all wisdom, singing psalms and hymns and spiritual songs, with thankfulness in your hearts to God. 17 And whatever you do, in word or deed, do everything in the name of the Lord Jesus, giving thanks to God the Father through him.

# SERMON NOTES

Put on a \_\_\_\_\_  
\_\_\_\_\_  
\_\_\_\_\_  
\_\_\_\_\_

## The Three Ultimate Questions:

\_\_\_\_\_ am I?

\_\_\_\_\_ do I fit?

\_\_\_\_\_ difference do I make?

“We are convinced that **TEENAGERS’**  
and **EMERGING ADULTS’** need to belong is  
ultimately met through the **UNCONDITIONAL**  
**LOVE OF COMMUNITY.”**

-*Growing Young*, “Empathize with Today’s  
Young People”

# SMALL GROUP REFLECTION QUESTIONS

READ COLOSSIANS 3:12-17

1. Empathy can be understood a lot of ways, but within *Growing Young*, it is defined as “feeling with,” or “sitting on the curb of a young person’s life, celebrating their dreams, and grieving over their despair”. What difference does it make for you when someone offers you empathy like this? Describe what it feels like.

---

---

---

---

2. Which of the three big questions—Who am I? Where do I fit? What difference do I make?—surfaced for you most when you were a teenager or young adult? What about today?

---

---

---

3. What shifts might we need to make in order to be a more hospitable place for young people’s journey toward identity, belonging, and purpose?

---

---

---

4. Give an example of someone you know or have known that had a “compassionate heart.” How was this compassionate heart shown in their actions and words?

---

---

---

# MOVING FORWARD THROUGH PRAYER

## WEEK 2 - EMPATHIZE WITH TODAY'S YOUNG PEOPLE

- Give thanks for the people in your upbringing who helped shape your identity, belonging, and/or purpose.
- Pray for our young people that they will believe Christ-centered narratives about themselves, ones based on grace, love, and mission. (They are enough, they belong with God's people, and they are part of God's greater story.)
- Pray that as we move into being a church that values young people, we will view them not as projects, but as people to "journey with".
- Consider the words of John 13:14-15. How do these words connect with the idea of empathy, "feeling with", toward another person? Pray for an opportunity to be this example to someone this week.



CHURCH · FAMILY · CELEBRATION

## SERMON SERIES

October 16, 2022

### ONE CELEBRATION: TAKE JESUS' MESSAGE SERIOUSLY

---

#### LUKE 9:18-25

Now it happened that as he was praying alone, the disciples were with him. And he asked them, “Who do the crowds say that I am?” 19 And they answered, “John the Baptist. But others say, Elijah, and others, that one of the prophets of old has risen.” 20 Then he said to them, “But who do you say that I am?” And Peter answered, “The Christ of God.”

21 And he strictly charged and commanded them to tell this to no one, 22 saying, “The Son of Man must suffer many things and be rejected by the elders and chief priests and scribes, and be killed, and on the third day be raised.”

23 And he said to all, “If anyone would come after me, let him deny himself and take up his cross daily and follow me. 24 For whoever would save his life will lose it, but whoever loses his life for my sake will save it. 25 For what does it profit a man if he gains the whole world and loses or forfeits himself?

# SERMON NOTES

\_\_\_\_\_ Jesus, \_\_\_\_\_ Jesus.

\_\_\_\_\_ Now More Than \_\_\_\_\_ Later

\_\_\_\_\_ Honesty Over \_\_\_\_\_ Certainty

\_\_\_\_\_ and \_\_\_\_\_ to Come on a Life Changing Journey

of Following Jesus.

## “TAKING JESUS’ MESSAGE SERIOUSLY

means churches pay attention to the life and words of **CHRIST**. Young people can then articulate a gospel that is less talk about beliefs and **MORE TALK ABOUT JESUS.**”

-*Growing Young*, “Take Jesus’ Message Seriously”

# SMALL GROUP REFLECTION QUESTIONS

READ LUKE 9:18-25

1. How are young people in our church invited to put their faith into action rather than simply focus on behaviors to avoid?

---

---

---

---

2. How are questions, struggles, and doubts about faith handled in our church?

---

---

---

---

3. In what ways are testimonies or faith journeys shared in our congregation? What could be some natural ways to share our faith with one another more, particularly in ways young people might access?

---

---

---

---

4. Christians do not go around every day carrying a wooden cross. What does Jesus mean when he challenges people to “take up his cross daily?”

---

---

---

---

# MOVING FORWARD THROUGH PRAYER

## WEEK 3 - TAKE JESUS' MESSAGE SERIOUSLY

- Pray that we would continue to be a church who takes Jesus' message seriously. Pray that we would not give in to the myths that watered-down teaching or hyper-entertaining programs are the only way to draw young people to church.
- Pray that individually and as a church we would boldly talk about the gospel and what Jesus means to us.
- Think about someone in your life, either past or present, that lives their life "moving in Jesus' direction". Praise God for that person and the impact they have had on your life.
- Pray that Celebration Church would be a safe place for people of all ages to ask tough questions. Pray that we would pursue faith-building responses with openness and honesty over having the "right answers".





CHURCH · FAMILY · CELEBRATION

## SERMON SERIES

October 23, 2022

### ONE CELEBRATION: FUEL A WARM COMMUNITY

---

#### I PETER 4:7-11

The end of all things is at hand; therefore be self-controlled and sober-minded for the sake of your prayers. 8 Above all, keep loving one another earnestly, since love covers a multitude of sins. 9 Show hospitality to one another without grumbling. 10 As each has received a gift, use it to serve one another, as good stewards of God's varied grace: 11 whoever speaks, as one who speaks oracles of God; whoever serves, as one who serves by the strength that God supplies—in order that in everything God may be glorified through Jesus Christ. To him belong glory and dominion forever and ever. Amen.

# SERMON NOTES

Show \_\_\_\_\_

Open \_\_\_\_\_

Open \_\_\_\_\_

Open \_\_\_\_\_



# SMALL GROUP REFLECTION QUESTIONS

READ I PETER 4:7-11

1. What are some of the obstacles to warmth (defined as authenticity, hospitality, caring, welcoming, accepting, belonging) in our congregation?

---

---

---

---

2. What is it like for newcomers to visit our church? How easy is it for newer people to access smaller gatherings in which they might feel relational connection?

---

---

---

---

3. Where do you see intergenerational relationships thriving in our church? What could foster more - and deeper - connection across generations?

---

---

---

---

4. List ways in which the church can show hospitality.

---

---

---

---

---

# MOVING FORWARD THROUGH PRAYER

## WEEK 4 - FUEL A WARM COMMUNITY

- Pray we will show Christ's love to everyone we interact with today, in spite of our differences.
- “Churches that are growing young do not always have elaborate structures or a myriad of programs. But one thing they do have is a feeling of warmth that makes young people want to participate in their congregation. Churches that are growing young are committed to fueling a warm community” (Griffin, Mulder, and Powell). Pray this for Celebration Church. May we be a church that allows people of all ages to feel “like family”.
- Pray for intergenerational relationships to thrive in our church so we can connect on a deeper level with one another.
- Young people want authentic relationships. What is one way you can connect with someone in a different generation than you? Pray for this to happen and for the boldness and courage to seize the opportunity when presented.



CHURCH · FAMILY · CELEBRATION

## SERMON SERIES

October 30, 2022

### ONE CELEBRATION: PRIORITIZE YOUNG PEOPLE EVERYWHERE

---

#### MARK 10:13-16

And they were bringing children to him that he might touch them, and the disciples rebuked them. 14 But when Jesus saw it, he was indignant and said to them, “Let the children come to me; do not hinder them, for to such belongs the kingdom of God. 15 Truly, I say to you, whoever does not receive the kingdom of God like a child shall not enter it.” 16 And he took them in his arms and blessed them, laying his hands on them.

# SERMON NOTES

We follow \_\_\_\_\_ when we \_\_\_\_\_ the young.

---

---

---

“One pastor of over 40 years put it like this: **EVERYBODY RISES** when you focus on children and teens.’ Adults in another church reflected, **YOUNG PEOPLE ARE LIKE SALT**. When they’re included, they make everything taste better.”

-*Growing Young*, “Prioritize Young People Everywhere”



# SMALL GROUP REFLECTION QUESTIONS

READ MARK 10:13-16

1. What evidence do you see that our congregation makes prioritizing young people everywhere a reality?

---

---

---

---

2. In what ways are young people given “load-bearing roles” in our church? What could we do to inspire more of a sense that our church needs the gifts young people uniquely bring?

---

---

---

---

3. How supported do parents and caregivers feel in our congregation? What might it look like to increase that support?

---

---

---

---

4. What does it mean to you to “receive the kingdom of God like a child?”

---

---

---

---

---

# MOVING FORWARD THROUGH PRAYER

## WEEK 5 - PRIORITIZE YOUNG PEOPLE EVERYWHERE

- Pray for the staff and leadership of the church for creativity to inspire and involve young people in more responsible roles.
- Pray for the young people already serving our church, that they will find joy in serving with the unique gifts they have been given.
- Pray that as a church we continue to “intentionally pay attention” to parents and caregivers. Pray we will prioritize the giving of support and training to provide for young people as they journey into adulthood.
- Pray for groups in our church-young people or otherwise- who may feel alienated, overlooked, or undervalued, that as we prioritize the inclusion of young people, it would not be to the exclusion of others. Pray that as a congregation we see these intentional moves as healthy for our church.



CHURCH · FAMILY · CELEBRATION

## SERMON SERIES

November 6, 2022

### ONE CELEBRATION: BE THE BEST NEIGHBOR

---

#### LUKE 10:25-29

And behold, a lawyer stood up to put him to the test, saying, “Teacher, what shall I do to inherit eternal life?” 26 He said to him, “What is written in the Law? How do you read it?” 27 And he answered, “You shall love the Lord your God with all your heart and with all your soul and with all your strength and with all your mind, and your neighbor as yourself.” 28 And he said to him, “You have answered correctly; do this, and you will live.” 29 But he, desiring to justify himself, said to Jesus, “And who is my neighbor?”

# SERMON NOTES

Moving Forward by Moving \_\_\_\_\_

Best neighbors \_\_\_\_\_

Best neighbors \_\_\_\_\_

Best neighbors \_\_\_\_\_ with others

Best neighbors start \_\_\_\_\_ and expand \_\_\_\_\_

“Churches striving to be the best neighbors reflect this **SELFLESS MERCY** toward people outside of their congregations...They demonstrate **COMPASSION AND FORGIVENESS**...Doing so earns these churches a hearing in a culture that otherwise dismisses them as judgmental or closed-minded.”

-*Growing Young*, “Be the Best Neighbors”

# SMALL GROUP REFLECTION QUESTIONS

READ LUKE 10:25-29

1. How do we answer the question “Who is my neighbor?” here at Celebration Church? How does that shape our engagement with the community and world?

---

---

---

---

2. If our church moved out of this neighborhood, for what would we be missed? Who would miss us most? What does this tell us?

---

---

---

---

3. What do ethnic and socioeconomic diversity look like at our church? How do we feel about that reality? What are we doing to build bridges toward greater diversity in our context?

---

---

---

---

4. Why do you think God tied love of neighbor in with the love of God?

---

---

---

---

---

# MOVING FORWARD THROUGH PRAYER

## WEEK 6 - BE THE BEST NEIGHBORS

- Pray that as a church we will respect our neighbor's journey as much as the destination. Pray that the Lord will reveal obstacles we intentionally or unintentionally put in the way of this effort.
- Pray for our congregation as we serve and engage others both locally and globally. Pray that we will not only serve well inside our church walls, but we will seek out new opportunities to "neighbor well".
- "Churches that are growing young are not focused on being the best church in their community. Rather, they are focused on being the best church for their community" (Griffin, Mulder, and Powell). Pray that as a congregation we will adopt and demonstrate this mindset.
- Consider Luke 10:25-29 and the definition of who our neighbors are, what it means to love them, and how this is an extension of loving God.





CHURCH · FAMILY · CELEBRATION



